

Ronald Reagan Presidential Library
Digital Library Collections

This is a PDF of a folder from our textual collections.

**Collection: President, Office of the: Presidential
Briefing Papers: Records, 1981-1989
Folder Title: 08/26/1983 (case file 163126)
Box: 34**

To see more digitized collections
visit: <https://reaganlibrary.gov/archives/digital-library>

To see all Ronald Reagan Presidential Library inventories visit:
<https://reaganlibrary.gov/document-collection>

Contact a reference archivist at: reagan.library@nara.gov

Citation Guidelines: <https://reaganlibrary.gov/citing>

National Archives Catalogue: <https://catalog.archives.gov/>

WITHDRAWAL SHEET

Ronald Reagan Library

Collection Name PRESIDENT, OFFICE OF THE: PRESIDENTIAL BRIEFING PAPERS

Withdrawer

RBW 1/7/2008

File Folder 08/26/1983 (CASEFILE 163126)

FOIA

S07-0077/01

Box Number

195

DOC NO	Doc Type	Document Description	No of Pages	Doc Date	Restrictions
1	SCHEDULE	OF THE PRESIDENT [PG 1, PARTIAL]	1	8/25/1983	B7(C)
2	MANIFEST	RE ELEVATOR	1	8/25/1983	B2 B7(E)
3	CHART	RE MARINE ONE AND AIR FORCE ONE	7	8/26/1983	B2 B7(E)

Freedom of Information Act - [5 U.S.C. 552(b)]

B-1 National security classified information [(b)(1) of the FOIA]

B-2 Release would disclose internal personnel rules and practices of an agency [(b)(2) of the FOIA]

B-3 Release would violate a Federal statute [(b)(3) of the FOIA]

B-4 Release would disclose trade secrets or confidential or financial information [(b)(4) of the FOIA]

B-6 Release would constitute a clearly unwarranted invasion of personal privacy [(b)(6) of the FOIA]

B-7 Release would disclose information compiled for law enforcement purposes [(b)(7) of the FOIA]

B-8 Release would disclose information concerning the regulation of financial institutions [(b)(8) of the FOIA]

B-9 Release would disclose geological or geophysical information concerning wells [(b)(9) of the FOIA]

C. Closed in accordance with restrictions contained in donor's deed of gift.

14

WHITE HOUSE
OFFICE OF RECORDS MANAGEMENT
WORKSHEET

TR

- X-MEDIA
- H-INTERNAL

Name of Document: BRIEFING PAPERS
FOR PRESIDENT'S
SCHEDULED
APPOINTMENTS FOR

AUG 26 83

Subject Codes:

P	R	0	0	7	-	0	1
TR		0	8	5	-		
					-		
					-		
					-		
					-		
					-		
					-		
					-		
LG		S	A	A			D
LG		S	A	N	T		A
					-		
WH		0	0	9	-	0	1
WH		0	0	9	-	0	2
					-		
					-		
					-		
					-		
					-		
					-		

Subject: ORM did not receive the President's
package for this day. Whether any
of the originals of these documents
copies
here attached were included in the
President's package is unknown.

1) Schedule of the President's trip to
San Diego and Santa Barbara.

- 2) Biographical sketches of Senators and
Congressmen scheduled to fly on
Air Force One or ride in one of the
A) BOBBI FIEDLER motorcoaches.
B) DUNCAN HUNTER
C) BILL LOWERY
D) RON PACKARD

ROUTE TO:		ACTION		DISPOSITION		
Office/Agency	(Staff Name)	Action Code	Tracking Date YY/MM/DD	Type of Response	Code	Completion Date YY/MM/DD
RMHENL		RSZ			C	

Referral Note:

WHITE HOUSE
OFFICE OF RECORDS MANAGEMENT
WORKSHEET

- X-MEDIA
- H-INTERNAL

Name of Document: BRIEFING PAPERS
FOR PRESIDENT'S
SCHEDULED
APPOINTMENTS FOR

AUG 26 83

Subject Codes:

P	R	0	0	7	-	0	1
					-		
P	L	0	0	2	-		
P	L	0	0	5	-	0	4
					-		
					-		
					-		
					-		
					-		
					-		
					-		
					-		
					-		
					-		
					-		
					-		
					-		
					-		
					-		
					-		
					-		
					-		

Subject:

3) Fund raising reception for
Congressman BOB LAGOMARSINO
at the home of BARNEY AND DIANE
KLINGER

ROUTE TO:		ACTION		DISPOSITION		
Office/Agency	(Staff Name)	Action Code	Tracking Date YY/MM/DD	Type of Response	Code	Completion Date YY/MM/DD
RMHENL		RSZ			C	

Referral Note:



**THE TRIP OF
THE PRESIDENT TO
SAN DIEGO & SANTA BARBARA,
CALIFORNIA**

August 26, 1983

WITHDRAWAL SHEET

Ronald Reagan Library

Collection Name

PRESIDENT, OFFICE OF THE: PRESIDENTIAL BRIEFING PAPERS

Withdrawer

RB 1/7/2008
W

File Folder

08/26/1983 (CASEFILE 163126)

FOIA

S07-0077/01

Box Number

195

<i>DOC Document Type</i>	<i>No of pages</i>	<i>Doc Date</i>	<i>Restrictions</i>
<i>NO Document Description</i>			
1 SCHEDULE OF THE PRESIDENT [PG 1, PARTIAL]	1	8/25/1983	B7(C)

Freedom of Information Act - [5 U.S.C. 552(b)]

- B-1 National security classified information [(b)(1) of the FOIA]
- B-2 Release would disclose internal personnel rules and practices of an agency [(b)(2) of the FOIA]
- B-3 Release would violate a Federal statute [(b)(3) of the FOIA]
- B-4 Release would disclose trade secrets or confidential or financial information [(b)(4) of the FOIA]
- B-6 Release would constitute a clearly unwarranted invasion of personal privacy [(b)(6) of the FOIA]
- B-7 Release would disclose information compiled for law enforcement purposes [(b)(7) of the FOIA]
- B-8 Release would disclose information concerning the regulation of financial institutions [(b)(8) of the FOIA]
- B-9 Release would disclose geological or geophysical information concerning wells [(b)(9) of the FOIA]

C. Closed in accordance with restrictions contained in donor's deed of gift.

THE WHITE HOUSE

WASHINGTON

TRIP OF THE PRESIDENT
FROM
LOS ANGELES
TO
SAN DIEGO AND SANTA BARBARA

FRIDAY, AUGUST 26, 1983

SAN DIEGO

EVENT: WESTERN WOMEN'S REPUBLICAN LEADERSHIP FORUM
DRESS: MEN'S BUSINESS SUIT, LADIES' AFTERNOON DRESS
WEATHER: MOSTLY SUNNY; LOW 80'S

SANTA BARBARA

EVENT: FUNDRAISING RECEPTION FOR CONG. ROBERT LAGOMARSINO AT
KLINGER RESIDENCE - HOPE RANCH
DRESS: MEN'S BUSINESS SUIT, LADIES' AFTERNOON DRESS
WEATHER: MOSTLY SUNNY; MID 80'S

ADVANCE

Los Angeles

San Diego

Hope Ranch

STAFF TERRY, GREY
PRESS BREIN, JEFF
USSS [REDACTED]
WHCA LITTLE, LARRY
MIL.AIDE DRENNAN, BILL

KREMER, CECE
HART, STEVE
[REDACTED]
OPFER, JIM
DRENNAN, BILL

GROOMES, KAREN
HATFIELD, MARK
[REDACTED]
BARGER, ED
DRENNAN, BILL

B7c

B7c

CONTACT

Presidential Advance Office
JAMES L. HOOLEY
KAREN JONES ROBERTS

LOS ANGELES SIGNAL: 213/552-7928
SAN DIEGO SIGNAL: 619/275-4830
SANTA BARBARA SIGNAL: 805/963-0925

08/25/83 4:00 p.m.

DETAILED SCHEDULE

GUEST AND STAFF INSTRUCTIONS
FOR THOSE MANIFESTED ON PRESS PLANE

7:00 a.m. BAGGAGE CALL: Bring baggage to lobby entrance.

8:00 a.m. Proceed to Lobby entrance for bus loading.

8:10 a.m. Press buses depart Century Plaza Hotel en route Los Angeles Intl. Airport.

9:20 a.m. Press plane departs Los Angeles Intl. Airport en route San Diego, California.

GUEST AND STAFF INSTRUCTIONS
FOR THOSE MANIFESTED ON AIR FORCE ONE TO
SAN DIEGO (AND SANTA BARBARA)

9:00 a.m. BAGGAGE CALL: Leave unlocked bags in rooms and hand carry all film.

9:30 a.m. Proceed to motorcade at C/D Level entrance for boarding.

GUEST AND STAFF INSTRUCTIONS
FOR THOSE MANIFESTED DIRECTLY TO SANTA
BARBARA

9:00 a.m. BAGGAGE CALL: Leave unlocked bags in rooms and hand carry all film.

9:40 a.m. THE PRESIDENT and Mrs. Reagan depart Suite en route motorcade for boarding.

CLOSED PRESS COVERAGE

9:45 a.m. THE PRESIDENT and Mrs. Reagan depart Century Plaza Hotel en route Santa Monica Airport.

Drive Time: 15 mins.

MOTORCADE ASSIGNMENTS

<u>Lead</u>	G. Terry
<u>Spare</u>	L. Speakes D. Fischer

08/25/83 4:00 p.m.

<u>Limo</u>	THE PRESIDENT Mrs. Reagan M. Reagan J. Baker
<u>Follow-up</u>	
<u>Control</u>	M. McManus Dr. E. Louie Military Aide
<u>Support</u>	E. Hickey Ofcl. Photographer Medic
<u>Staff I</u>	R. Darman E. Rollins
<u>Staff II</u>	K. Duberstein F. Whittlesey J. Poindexter
<u>WHCA</u>	
<u>ID</u>	
<u>Camera I</u>	J. Brein
<u>Wire I</u>	
<u>Wire II</u>	
<u>Press Van</u>	
<u>Guest/Staff Van</u>	All others
<u>Ambulance</u>	
<u>Tail</u>	

9:55 a.m. Press plane arrives Lindbergh Field, San Diego, California.

10:00 a.m. THE PRESIDENT and Mrs. Reagan arrive Santa Monica Airport and proceed to Marine One for boarding.

See Tab A for diagram.

OPEN PRESS COVERAGE
CLOSED ARRIVAL/DEPARTURE

GUEST AND STAFF INSTRUCTIONS

Board assigned helicopters immediately.

See attached AIRCRAFT SEATING DIAGRAMS for helicopter manifests.

10:05 a.m. Marine One departs Santa Monica Airport en route Los Angeles International Airport.

Flight Time: 10 mins.

10:06 a.m. Nighthawk Two departs Santa Monica Airport en route Los Angeles International Airport.

10:07 a.m. Press Helicopter departs Santa Monica Airport en route Los Angeles International Airport.

10:13 a.m. Press Helicopter arrives TWA Maintenance Ramp, Los Angeles Intl. Airport.

10:14 a.m. Nighthawk Two arrives TWA Maintenance Ramp, Los Angeles Intl. Airport.

10:15 a.m. Marine One arrives TWA Maintenance Ramp, Los Angeles Intl. Airport.

See Tab B for diagram.

OPEN PRESS COVERAGE
CLOSED ARRIVAL/DEPARTURE

THE PRESIDENT and Mrs. Reagan proceed to Air Force One for boarding.

GUEST AND STAFF INSTRUCTIONS

Board Air Force One immediately.

See attached AIRCRAFT SEATING DIAGRAMS for Air Force One manifest.

10:20 a.m. Air Force One departs Los Angeles, California en route San Diego, California.

Flight Time: 35 mins.
Time Change: None
Food Service: Snacks

10:55 a.m. Air Force One arrives PSA Ramp, Lindbergh Field, San Diego, California.

See Tab C for diagram.

OPEN PRESS COVERAGE
CLOSED ARRIVAL/DEPARTURE

THE PRESIDENT and Mrs. Reagan deplane and are met at the base of Air Force One steps by:

Congressman Duncan Hunter (R-Calif-45)
Congressman Bill Lowery (R-Calif-41)
Congressman Ron Packard (R-Calif-43)
Mayor Roger Hedgecock (R-San Diego)
Mayor George Cox (R-Chula Vista)

GUEST AND STAFF INSTRUCTIONS

Board assigned vehicles immediately.

THE PRESIDENT and Mrs. Reagan proceed to motorcade for boarding.

11:00 a.m. THE PRESIDENT and Mrs. Reagan depart Lindbergh Field en route Bahia Hotel.

Drive Time: 10 mins.

MOTORCADE ASSIGNMENTS

<u>Lead</u>	C. Kremer
<u>Spare</u>	L. Speakes D. Fischer
<u>Limo</u>	THE PRESIDENT Mrs. Reagan M. Reagan J. Baker
<u>Follow-up</u>	

<u>Control</u>	M. McManus Dr. Eric Louie Military Aide
<u>Support</u>	E. Hickey J. Hooley Ofcl. Photographer Medic
<u>Staff I</u>	R. Darman K. Duberstein E. Rollins
<u>Guest I</u>	Cong. Hunter Cong. Lowery Cong. Packard
<u>Guest II</u>	Cong. Fiedler F. Whittlesey
<u>WHCA</u>	
<u>ID</u>	
<u>Camera I</u>	S. Hart
<u>Wire I</u>	
<u>Wire II</u>	
<u>Camera II</u>	
<u>Camera III</u>	
<u>Camera IV</u>	
<u>Press Van I</u>	M. Weinberg
<u>Press Van II</u>	
<u>Guest/Staff Van</u>	
<u>Ambulance</u>	
<u>Tail</u>	

11:10 a.m. THE PRESIDENT and Mrs. Reagan arrive Gleason Avenue entrance, Bahia Hotel, 998 W. Mission Bay Drive, and proceed inside.

See Tab D for diagram.

08/25/83 4:00 p.m.

WITHDRAWAL SHEET

Ronald Reagan Library

Collection Name

PRESIDENT, OFFICE OF THE: PRESIDENTIAL BRIEFING PAPERS

Withdrawer

RB 1/7/2008
W

File Folder

08/26/1983 (CASEFILE 163126)

FOIA

S07-0077/01

Box Number

195

<i>DOC Document Type</i>	<i>No of</i>	<i>Doc Date</i>	<i>Restric-</i>
<i>NO Document Description</i>	<i>pages</i>		<i>tions</i>
2 MANIFEST RE ELEVATOR	1	8/25/1983	B2 B7(E)

Freedom of Information Act - [5 U.S.C. 552(b)]

- B-1 National security classified information [(b)(1) of the FOIA]
- B-2 Release would disclose internal personnel rules and practices of an agency [(b)(2) of the FOIA]
- B-3 Release would violate a Federal statute [(b)(3) of the FOIA]
- B-4 Release would disclose trade secrets or confidential or financial information [(b)(4) of the FOIA]
- B-6 Release would constitute a clearly unwarranted invasion of personal privacy [(b)(6) of the FOIA]
- B-7 Release would disclose information compiled for law enforcement purposes [(b)(7) of the FOIA]
- B-8 Release would disclose information concerning the regulation of financial institutions [(b)(8) of the FOIA]
- B-9 Release would disclose geological or geophysical information concerning wells [(b)(9) of the FOIA]

C. Closed in accordance with restrictions contained in donor's deed of gift.

11:15 a.m. THE PRESIDENT and Mrs. Reagan depart holding room en route Mission Bay Room for Western Women's Republican Leadership Forum.

See Tab E for diagram.

THE PRESIDENT and Mrs. Reagan arrive off-stage announcement area.

Announcement (off-stage)

OPEN PRESS COVERAGE

THE PRESIDENT and Mrs. Reagan proceed to dais and are seated.

See Tab E-1 for diagram.

Betty Heitman, Co-Chairman, Republican National Committee makes brief remarks and introduces THE PRESIDENT.

11:20 a.m. THE PRESIDENT proceeds to podium and makes remarks.

OPEN PRESS COVERAGE

11:35 a.m. THE PRESIDENT concludes remarks and, joined by Mrs. Reagan, departs dais en route holding room.

Refer to Tab E for diagram.

GUEST AND STAFF INSTRUCTIONS

Guests and staff will be escorted to Room 602 (first floor) for brief refreshments.

THE PRESIDENT and Mrs. Reagan arrive holding room.

STAFF TIME: 20 mins.

GUEST AND STAFF INSTRUCTIONS

11:50 a.m. Guests and staff will be escorted to motorcade for boarding.

11:55 a.m. THE PRESIDENT and Mrs. Reagan depart holding room en route motorcade for boarding.

Refer to Tab E for diagram.

OPEN PRESS COVERAGE
CLOSED DEPARTURE

12:00 noon THE PRESIDENT and Mrs. Reagan depart Bahia Hotel en route Lindbergh Field.

Drive Time: 10 mins.

MOTORCADE ASSIGNMENTS

<u>Lead</u>	C. Kremer
<u>Spare</u>	L. Speakes D. Fischer
<u>Limo</u>	THE PRESIDENT Mrs. Reagan M. Reagan J. Baker
<u>Follow-up</u>	
<u>Control</u>	M. McManus Dr. Eric Louie Military Aide
<u>Support</u>	E. Hickey J. Hooley Ofcl. Photographer Medic
<u>Staff I</u>	R. Darman K. Duberstein E. Rollins
<u>WHCA</u>	
<u>ID</u>	
<u>Camera I</u>	S. Hart
<u>Wire I</u>	
<u>Wire II</u>	
<u>Camera II</u>	
<u>Camera III</u>	

<u>Camera IV</u>	
<u>Press Van I</u>	M. Weinberg
<u>Press Van II</u>	
<u>Guest/Staff Van</u>	All others
<u>Ambulance</u>	
<u>Tail</u>	

12:10 p.m. THE PRESIDENT and Mrs. Reagan arrive PSA Ramp, Lindbergh Field, and proceed to Air Force One for boarding.

Refer to Tab C for diagram.

OPEN PRESS COVERAGE
CLOSED DEPARTURE

<u>GUEST AND STAFF INSTRUCTIONS</u> Board Air Force One immediately.

See attached AIRCRAFT SEATING DIAGRAMS for Air Force One manifest.

12:15 p.m. Air Force One departs San Diego, California en route Oxnard, California.

Flight Time: 35 mins.
Time Change: None
Food Service: Light Lunch

12:35 p.m. Press buses depart Bahia Hotel en route Lindbergh Field.

1:05 p.m. Press plane departs San Diego, California en route Santa Barbara Airport.

12:50 p.m. Air Force One arrives Pt. Mugu Naval Air Station.

OPEN PRESS COVERAGE
CLOSED ARRIVAL/DEPARTURE

THE PRESIDENT and Mrs. Reagan deplane and proceed to Marine One for boarding.

GUEST AND STAFF INSTRUCTIONS

Board assigned helicopters immediately.

See attached AIRCRAFT SEATING DIAGRAMS for helicopter manifests.

- 12:55 p.m. Marine One departs Pt. Mugu NAS en route Hope Ranch.
Flight Time: 35 mins.
- 12:56 p.m. Nighthawk Two departs Pt. Mugu NAS en route Hope Ranch.
- 12:57 p.m. Press Helicopter departs Pt. Mugu NAS en route Hope Ranch.
- 1:40 p.m. Press plane arrives Santa Barbara Airport.
- 1:18 p.m. Press Helicopter arrives Hope Ranch landing zone.
- 1:19 p.m. Nighthawk Two arrives Hope Ranch landing zone.
- 1:20 p.m. Marine One arrives Hope Ranch landing zone.

See Tab F for diagram.

OPEN PRESS COVERAGE
CLOSED ARRIVAL/DEPARTURE

THE PRESIDENT and Mrs. Reagan deplane and are met by:

Congressman Robert Lagomarsino
(R-Calif-19)
Mrs. Norma Lagomarsino

GUEST AND STAFF INSTRUCTIONS

Board assigned vehicles immediately.

THE PRESIDENT and Mrs. Reagan, accompanied by Congressman and Mrs. Lagomarsino, proceed to motorcade for boarding.

- 1:25 p.m. THE PRESIDENT and Mrs. Reagan depart Hope Ranch landing zone en route Klinger Residence.

Drive Time: 5 mins.

MOTORCADE ASSIGNMENTSLeadSpareL. Speakes
D. FischerLimoTHE PRESIDENT
Mrs. Reagan
Cong. Lagomarsino
Mrs. Lagomarsino
J. BakerFollow-upControlM. McManus
Dr. E. Louie
Military AideSupportJ. Hooley
Ofcl. Photographer
MedicStaff IR. Darman
K. Duberstein
E. RollinsWHCAIDCamera I

M. Hatfield

Wire IWire IIPress Van

M. Weinberg

Guest/Staff Van

All others

AmbulanceTail

1:30 p.m. THE PRESIDENT and Mrs. Reagan, accompanied by
Congressman and Mrs. Lagomarsino, arrive Klinger
Residence and proceed inside.

08/25/83 4:00 p.m.

See Tab G for diagram.

OFFICIAL PHOTOGRAPHER ONLY

Met by:

Mr. Barney Klinger
Mrs. Diane Klinger

GUEST AND STAFF INSTRUCTIONS

Guests and staff will be escorted to guest and staff area in reception.

1:35 p.m. THE PRESIDENT and Mrs. Reagan participate in photo session with Congressman Lagomarsino's California staff.

OFFICIAL PHOTOGRAPHER ONLY

NOTE: Cong. and Mrs. Lagomarsino proceed outside to dais.

1:40 p.m. THE PRESIDENT and Mrs. Reagan proceed to off-stage announcement area.

Refer to Tab G for diagram.

Announcement (off-stage)

THE PRESIDENT and Mrs. Reagan proceed outside to dais.

DAIS ARRANGEMENT
(Stage Left to Stage Right):

THE PRESIDENT
Mrs. Reagan
Mrs. Lagomarsino
Cong. Lagomarsino

OFFICIAL PHOTOGRAPHER ONLY

Congressman Lagomarsino introduces THE PRESIDENT.

1:45 p.m. THE PRESIDENT makes brief remarks.

OFFICIAL PHOTOGRAPHER ONLY

1:50 p.m. THE PRESIDENT concludes remarks and, joined by Mrs. Reagan, proceeds to motorcade for boarding.

NOTE: THE PRESIDENT will shake hands along the ropeline upon departure.

GUEST AND STAFF INSTRUCTIONS

Proceed to motorcade immediately.

1:55 p.m. THE PRESIDENT and Mrs. Reagan depart Klinger Residence en route Hope Ranch landing zone.

Drive Time: 5 mins.

MOTORCADE ASSIGNMENTS

Same as on arrival with the following changes:

<u>Limo</u>	THE PRESIDENT Mrs. Reagan J. Baker
-------------	--

2:00 p.m. THE PRESIDENT and Mrs. Reagan arrive landing zone and proceed to Marine One for boarding.

Refer to Tab F for diagram.

OPEN PRESS COVERAGE

GUEST AND STAFF INSTRUCTIONS

Those guests and staff manifested on Marine One and Nighthawk Two should board assigned helicopters immediately.

All others will be provided transportation to the Sheraton Santa Barbara and Santa Barbara Biltmore hotels.

See attached AIRCRAFT SEATING DIAGRAMS for helicopter manifests.

2:05 p.m. Marine One departs Hope Ranch en route Rancho del Cielo.

Flight Time: 10 mins.

2:06 p.m. Nighthawk Two departs Hope Ranch en route Rancho del Cielo.

2:14 p.m. Nighthawk Two arrives Rancho del Cielo.

2:15 p.m. Marine One arrives Rancho del Cielo landing zone.

CLOSED PRESS COVERAGE

THE PRESIDENT and Mrs. Reagan proceed to ranch house via vehicle.

GUEST AND STAFF INSTRUCTIONS

Those manifested on Nighthawk Two should board immediately.

2:20 p.m. THE PRESIDENT and Mrs. Reagan arrive ranch house.

PRIVATE TIME: Remainder of Day

REMAIN OVERNIGHT: Rancho del Cielo

2:25 p.m.* Nighthawk Two departs Rancho del Cielo en route Santa Barbara Airport.

2:35 p.m.* Nighthawk Two arrives Santa Barbara Airport.

GUEST AND STAFF INSTRUCTIONS

Guests and staff will be provided transportation to the Santa Barbara Biltmore and Sheraton Santa Barbara.

Sheraton Santa Barbara: Proceed to Staff Office, Room 102, for room keys. Press staff should proceed to Vista Mar Monte for room keys.

Santa Barbara Biltmore: Proceed to Staff Office, Room 70, for room keys.

Baggage will be delivered to rooms.

* Denotes approximate times.

TABS

TAB A
 LOS ANGELES, CA.
 Santa Monica Airport
 Departure Diagram
 Friday, August 26, 1983

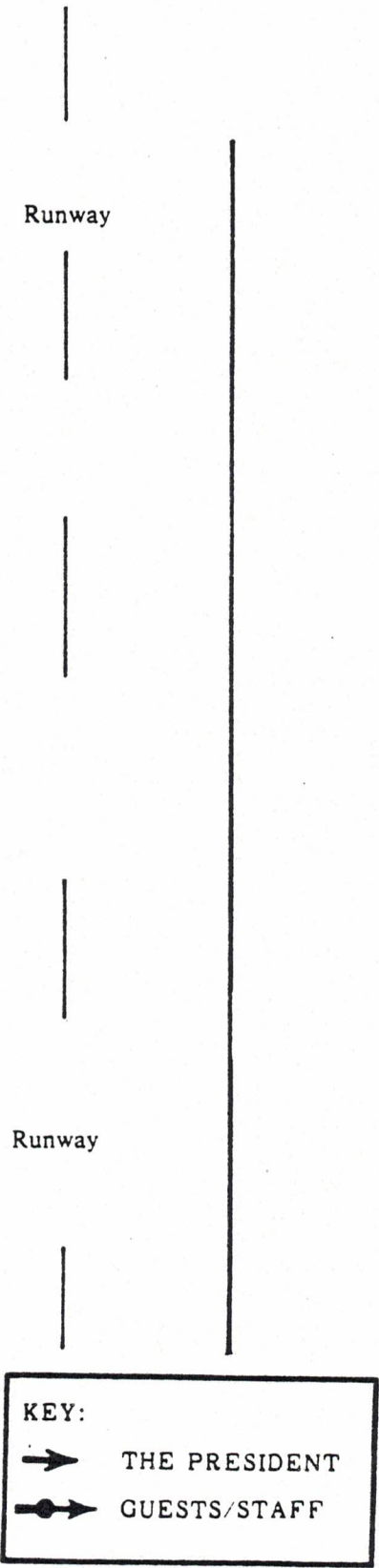
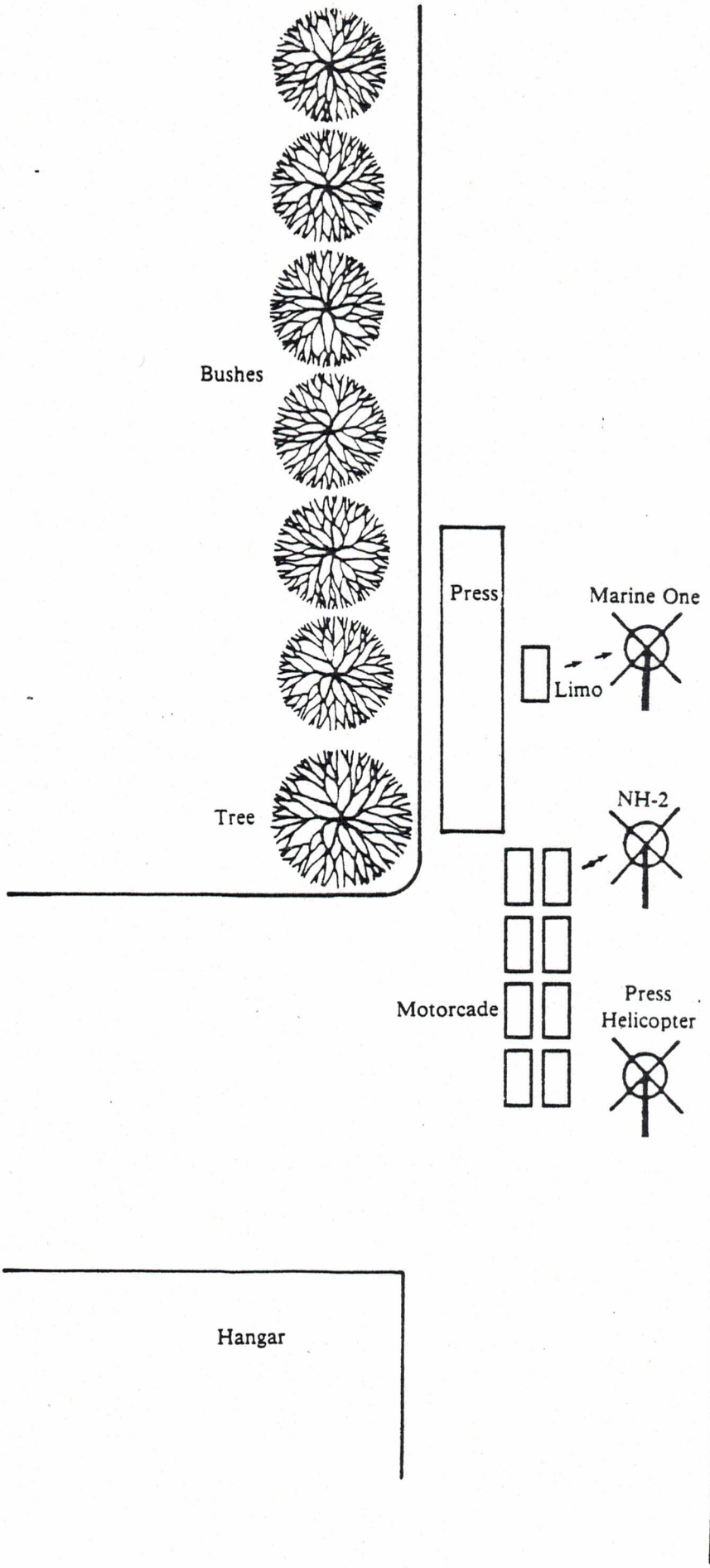

TAB B

LOS ANGELES, CA.

Los Angeles
International Airport
TWA Maintenance Ramp
Arrival/Departure Diagram
Friday, August 26, 1983

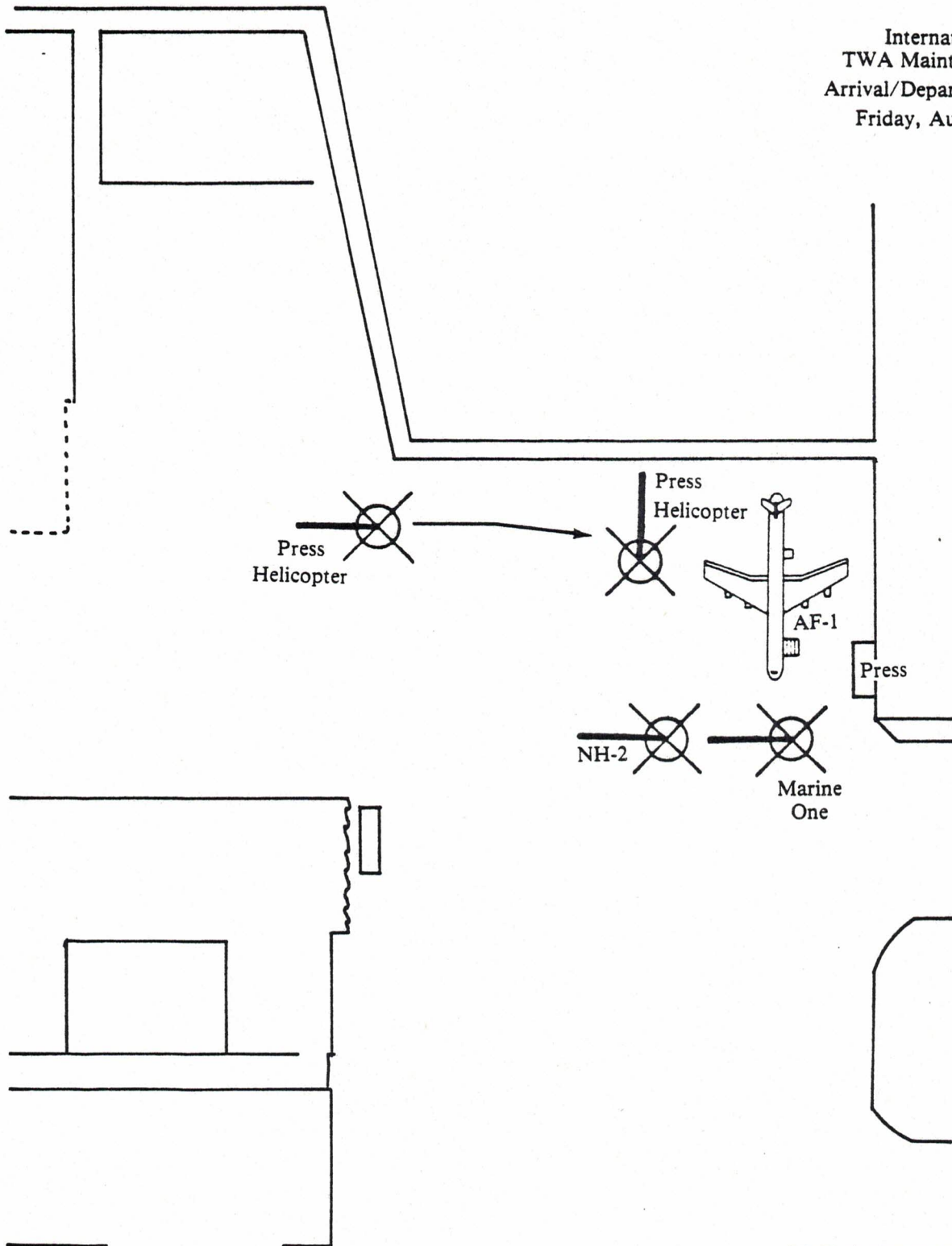

KEY:
→ THE PRESIDENT

TAB C
 SAN DIEGO, CA.
 Lindbergh Field
 PSA Ramp
 Arrival/Departure Diagram
 Friday, August 26, 1983

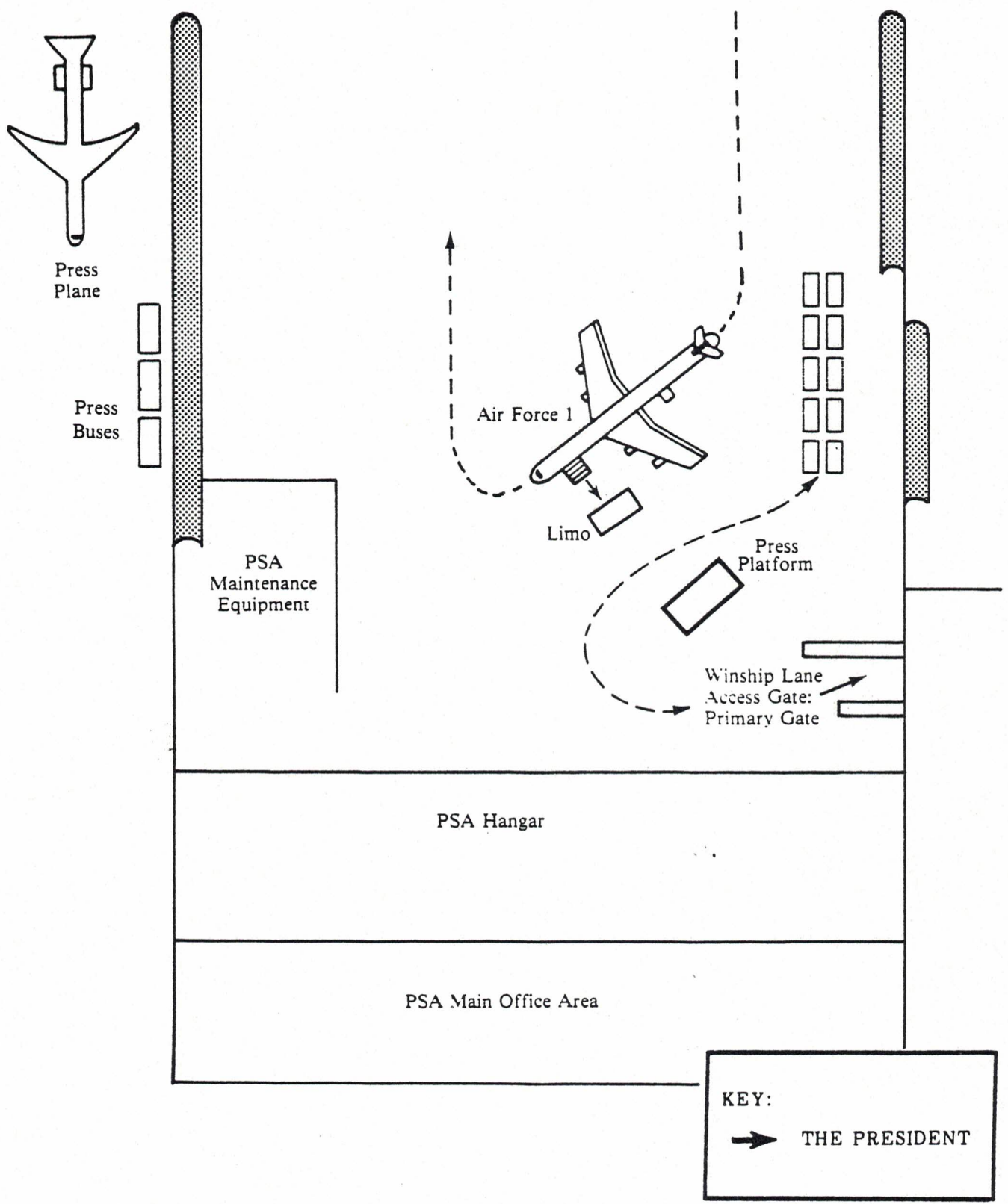

TAB D
SAN DIEGO, CA.
Bahia Hotel
Arrival Diagram
Friday, August 26, 1983

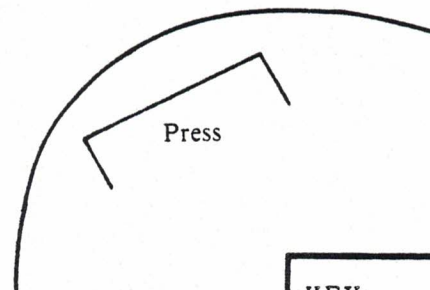
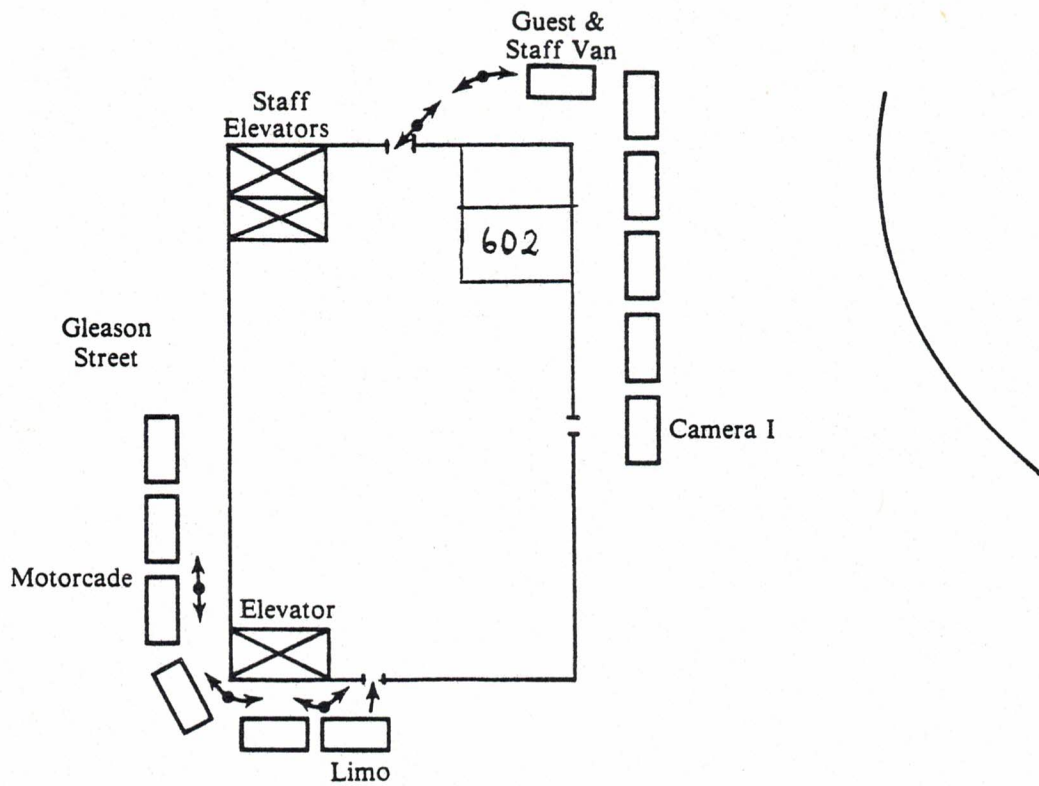

KEY:

- THE PRESIDENT
- GUESTS/STAFF

TAB E
SAN DIEGO, CA.
 GOP Women's Leadership Forum
 Bahia Hotel
 Mission Bay Room
 5th Floor
 Friday, August 26, 1983

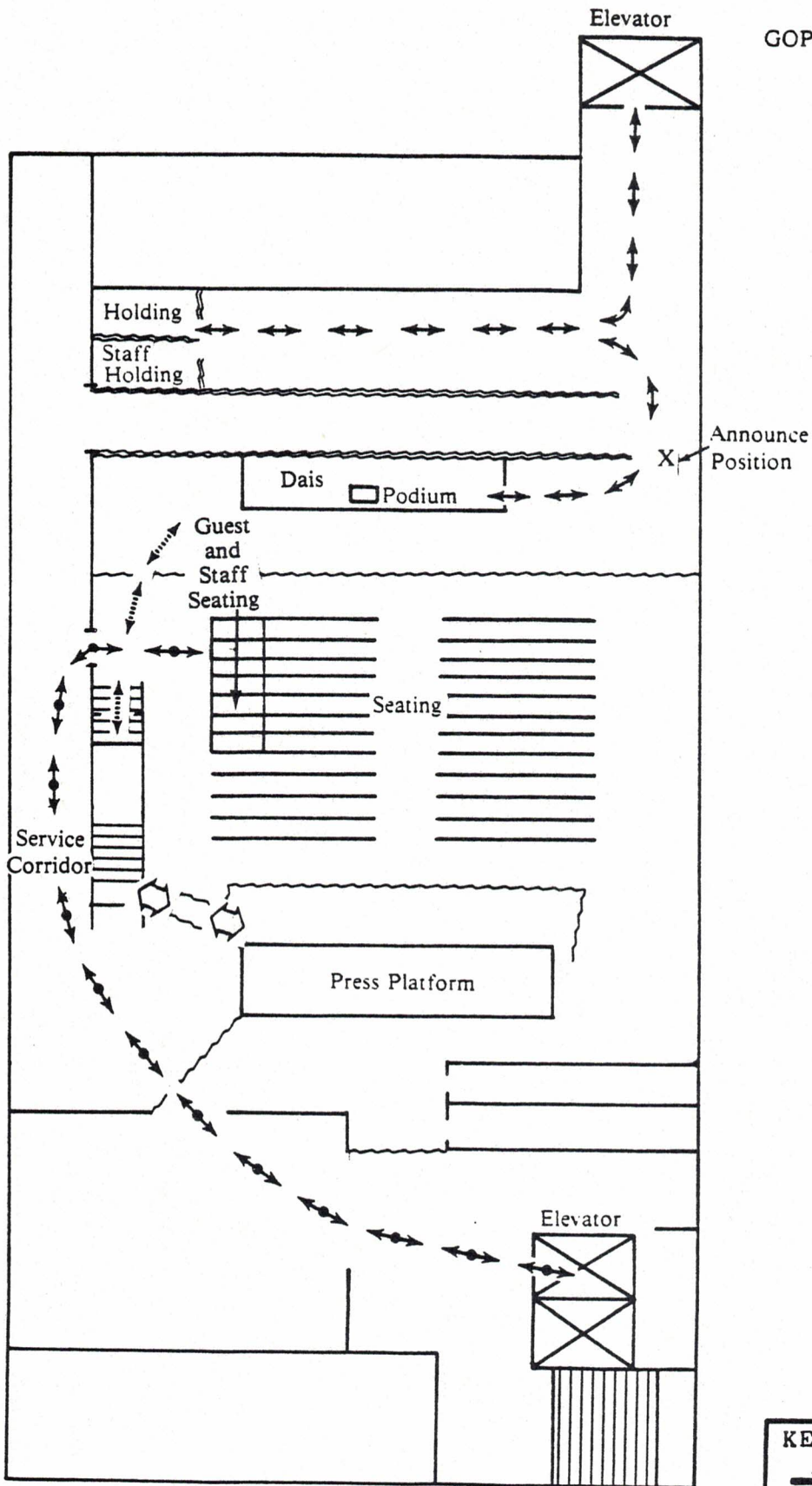

KEY:

- THE PRESIDENT
- GUESTS/STAFF
- PRESS POOL
- PRESS

TAB E-1

SAN DIEGO, CALIF.
Bahia Hotel
Fri. Aug. 26, 1983

Dais Arrangement

Zenda Hull, Republican National Committeewoman, Utah
Eileen Schouweiler, Republican National Committeewoman, Nevada
Carla Corey, Republican National Committeewoman, Hawaii
A Trudy McDonald, Republican National Committeewoman, California
U Mrs. Reagan
D Betty Heitman, Co-Chairman, Republican National Committee
I
E PODIUM
N Congresswoman Bobbi Fiedler (R-Calif-21)
C THE PRESIDENT
E Betty Rendel, President, National Federation of Republican
Women
Faith Ryan Whittlesey, Assistant to the President
Maureen Reagan
Jennifer Dunn, Chairwoman, Republican Party of Washington State

08/25/83 4:00 p.m.

TAB F
SANTA BARBARA, CA.
Hope Ranch
Landing Zone
Friday, August 26, 1983

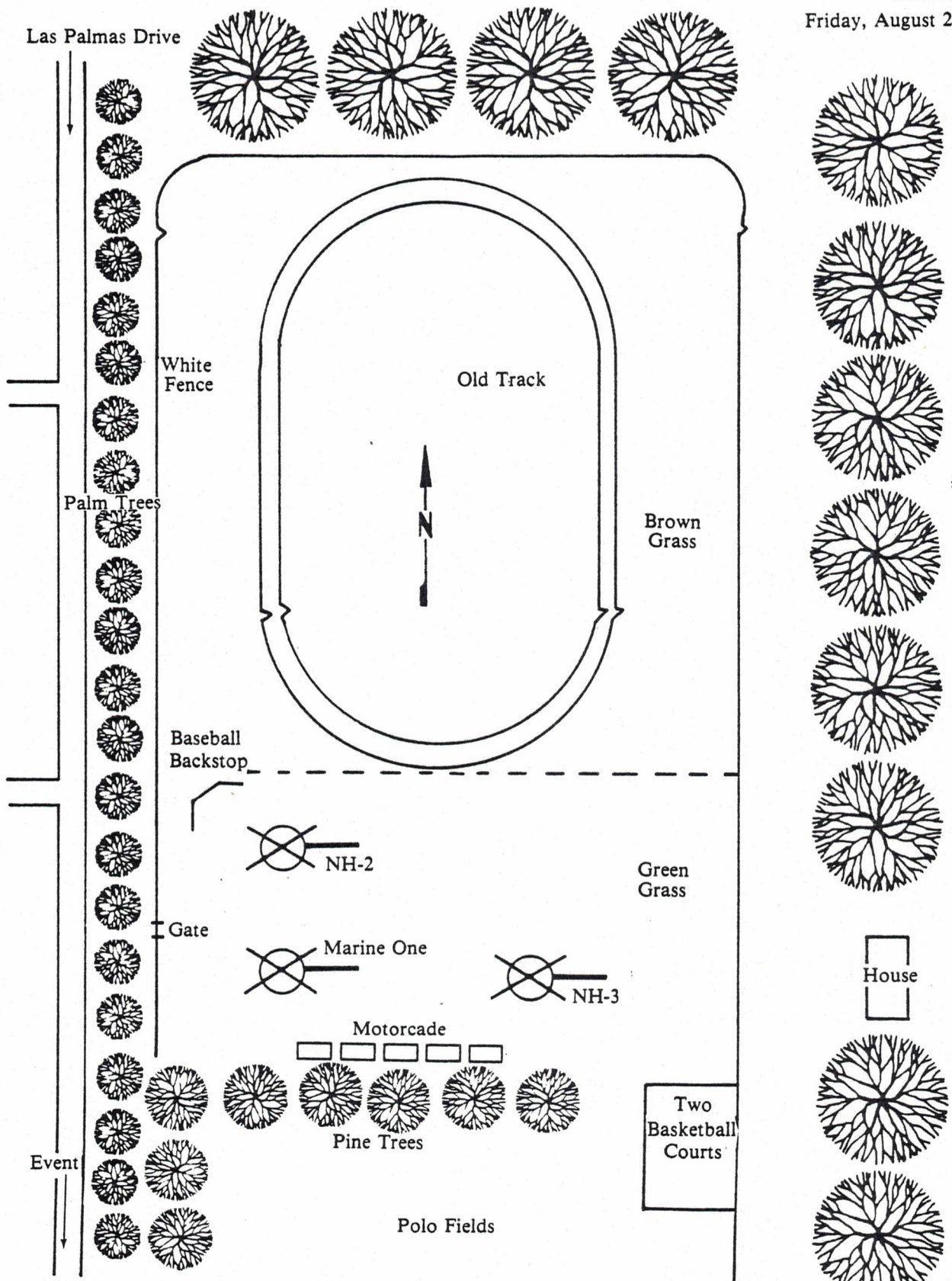

TAB G
 SANTA BARBARA, CA.
 Klinger Residence
 Friday, August 26, 1983

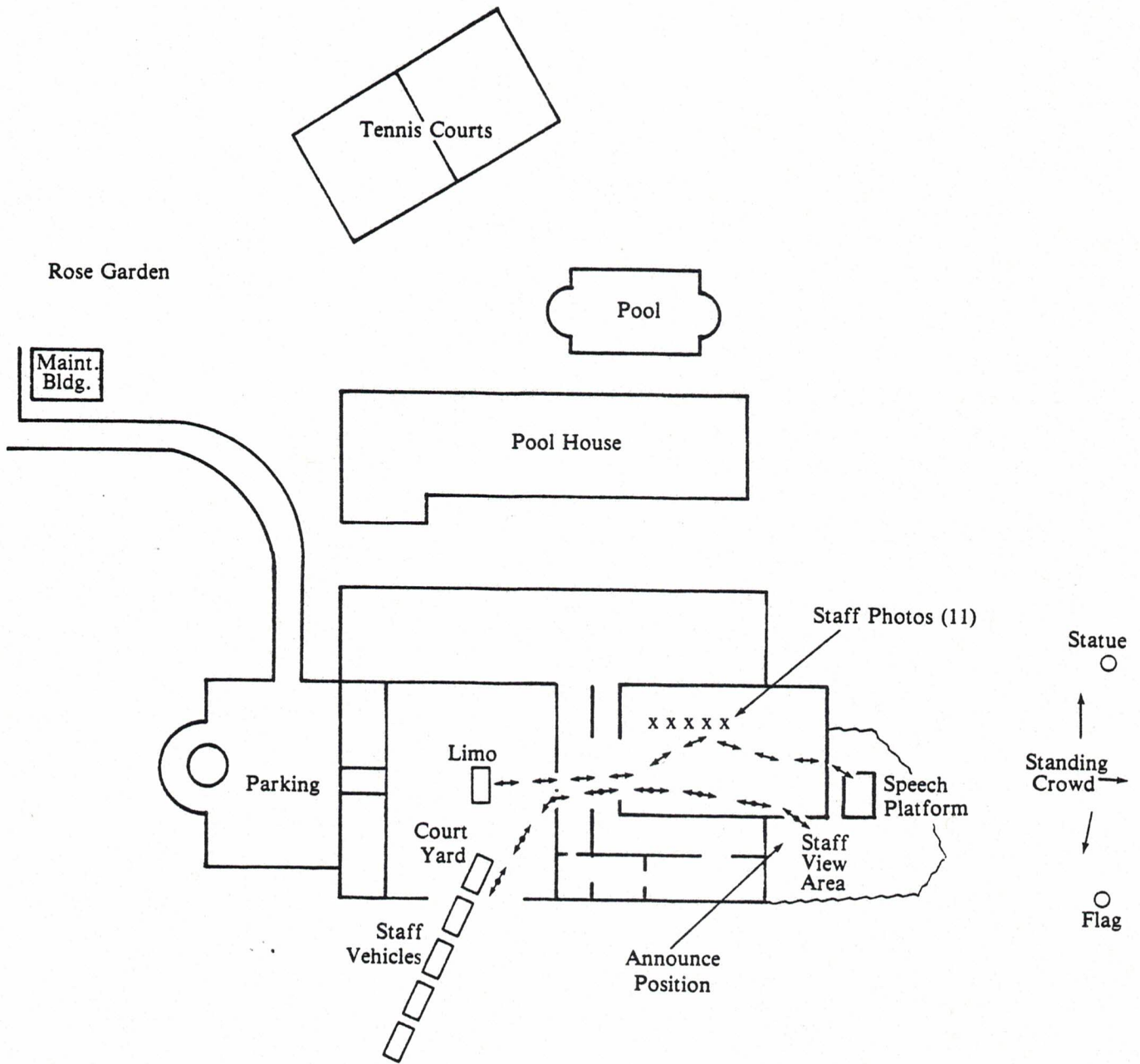

Press Vehicles Outside Front Gate

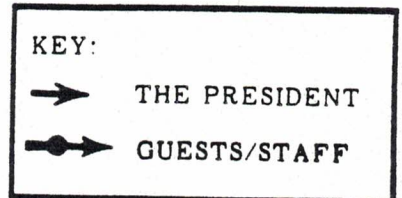

AIRCRAFT SEATING
DIAGRAMS

WITHDRAWAL SHEET

Ronald Reagan Library

Collection Name

PRESIDENT, OFFICE OF THE: PRESIDENTIAL BRIEFING PAPERS

Withdrawer

RB 1/7/2008
W

File Folder

08/26/1983 (CASEFILE 163126)

FOIA

S07-0077/01

Box Number

195

DOC Document Type

NO Document Description

*No of
pages*

Doc Date

*Restric-
tions*

3 CHART

7 8/26/1983 B2

RE MARINE ONE AND AIR FORCE ONE

B7(E)

Freedom of Information Act - [5 U.S.C. 552(b)]

B-1 National security classified information [(b)(1) of the FOIA]

B-2 Release would disclose internal personnel rules and practices of an agency [(b)(2) of the FOIA]

B-3 Release would violate a Federal statute [(b)(3) of the FOIA]

B-4 Release would disclose trade secrets or confidential or financial information [(b)(4) of the FOIA]

B-6 Release would constitute a clearly unwarranted invasion of personal privacy [(b)(6) of the FOIA]

B-7 Release would disclose information compiled for law enforcement purposes [(b)(7) of the FOIA]

B-8 Release would disclose information concerning the regulation of financial institutions [(b)(8) of the FOIA]

B-9 Release would disclose geological or geophysical information concerning wells [(b)(9) of the FOIA]

C. Closed in accordance with restrictions contained in donor's deed of gift.

THE WHITE HOUSE
WASHINGTON

→ 7:20 p.m.

August 25, 1983

PLEASE DACOM IMMEDIATE TO:

RICHARD G. DARMAN

FROM: Kathy Reid

Received SS
1983 AUG 25 PM 5:55

THE WHITE HOUSE
WASHINGTON

August 25, 1983

MEMORANDUM FOR DICK DARMAN

FROM: KEN DUBERSTEIN *Ken D.*

Attached is biographical information on the members of Congress who will be participating in portions of the activities in which the President will be involved in San Diego on Friday, August 26.

Congresswoman Bobbi Fiedler will travel on Air Force 1 from Los Angeles to San Diego with the President. Congressmen Duncan Hunter, Bill Lowery and Ron Packard will meet the President at the airport and all 4 members will join the motorcade to the Bahia Hotel. These members will not accompany the President when he returns to the airport; they will depart the hotel independently.

CONGRESSMAN RON PACKARD
(REPUBLICAN - CALIFORNIA)

Congressman Packard represents the 43rd District of California which includes Carlsbad (where he previously served as mayor), and parts of San Diego.

Presently serving his first term, Congressman Packard won election as a write-in candidate, becoming only the second Congressional candidate since 1958 to successfully run as a write-in.

Packard sits on the Education and Labor and Public Works and Transportation Committees. He has been a consistent supporter of Administration policies.

Congresswoman Bobbi Fiedler (R-CA) Ms. Fiedler represents the twenty-first district of California which includes the community of Northridge and part of Ventura County. Congresswoman Fiedler is a sophomore serving on the House Budget Committee. Although she recently opposed the IMF replenishment, she has actively and effectively supported the President's program. Ms. Fiedler is currently turning her attention to women's issues in an effort to narrow the gender gap. She has met with the President and various White House officials to discuss these issues.

CONGRESSMAN DUNCAN HUNTER
(REPUBLICAN - CALIFORNIA)

Congressman Hunter represents the 45th District of California, which includes Coronado and parts of San Diego, and is presently serving his second term in Congress.

Duncan sits on the House Armed Services Committee and has been a consistent supporter of Administration policies, especially on defense and Central American issues. He currently serves as the Republican Sophomore Class President, and has asked the President to help raise money for members of his class who were defeated, but are considering running again.

CONGRESSMAN BILL LOWERY
(REPUBLICAN - CALIFORNIA)

Congressman Lowery represents the 41st District of California, which includes parts of San Diego, and is presently serving his second term in Congress.

Congressman Lowery sits on the Banking, Finance and Urban Affairs and Science and Technology Committees. He has been a strong supporter of Administration policies.

Bill and other San Diego Members have been concerned about pollution problems created by sewage from Mexico. This was to be discussed during the recent meetings with President de la Madrid.

6:15 p.m.

8/25

Per CLF, RGD says not
to dacom this to him —
he has it from Advance.

KR

THE WHITE HOUSE

WASHINGTON

SCHEDULE OF THE PRESIDENT

FRIDAY, AUGUST 26, 1983

Los Angeles/San Diego/Santa Barbara

EVENTS: 1) Western Women's Republican Leadership Forum
2) Fundraising Reception for Congressman Robert Lagomarsino

DRESS: Men's Business Suit

LOS ANGELES WEATHER: Mostly Sunny; Mid 80's

SAN DIEGO WEATHER: Mostly Sunny; Low 80's

SANTA BARBARA WEATHER: Mostly Sunny; Low 80's

9:40 a.m. With Mrs. Reagan, depart Suite en route motorcade for boarding. - CLOSED PRESS

9:45 a.m. Depart Century Plaza Hotel en route Santa Monica Airport. Drive Time: 15 mins. In Limo: Mrs. Reagan; M. Reagan; J. Baker.

10:00 a.m. Arrive airport and proceed to Marine One for boarding. - OPEN PRESS

10:05 a.m. Marine One departs en route Los Angeles Intl. Airport.
Flight Time: 10 mins.
Guests Aboard: Maureen Reagan

10:15 a.m. Marine One arrives airport. Proceed to Air Force One and board. - OPEN PRESS

10:20 a.m. Air Force One departs Los Angeles en route San Diego.
Flight Time: 35 mins.
Time Change: None
Food Service: Snacks
Guests Aboard: Maureen Reagan
Cong. Bobbi Fiedler (R-Calif-21)

10:55 a.m. Air Force One arrives Lindbergh Field, San Diego. Deplane. - OPEN PRESS

08/25/83 4:00 p.m.